



FAIRWAY — DÉCOR —

PRODUCT CATALOG JULY 2025





Elegant &
Understated

TRANSFORM YOUR HOME WITH Fairway Shutters

At Fairway Shutters, we specialize in custom-made premium shutters that elevate the look and feel of your home by combining timeless elegance, practical functionality, and long-lasting value.

Our shutters offer a wide range of benefits, including:

- Superior Light Control
- Enhanced Privacy
- Stylish Aesthetic Appeal
- Effective Sun Blocking

Each shutter is meticulously crafted using only the finest materials—premium basswood, solid body vinyl with aluminum reinforcement, or high-quality composite. With a wide selection of colors and the ability to fit virtually any window shape, our shutters are tailored to suit your unique space and style.

Whether you're enhancing your home's interior or increasing its value, Fairway Shutters delivers quality and craftsmanship you can trust.

SHUTTER TYPES

FAIRWAY SHUTTERS TIMELESS AND ELEGANT



MODEL	ANAHEIM BASSWOOD PAINTED – PREMIUM	LAGUNA BASSWOOD STAINED – LUXURY	CARLSBAD POLY PAINTED – UNDESTROYABLE	PASADENA COMPOSITE – ECONOMICAL
SIZE	36" panel width limit for all shutters 60" max length for hidden tilt or inviz tilt without split 70" Maximum height without divider rail for structural integrity			
SPECIALTY SHAPES	Drawings are provided			
PREMIUM OPTIONS	a. Hidden tilt rods (tilt rods connects louvers in the back of shutter panels) b. Inviz tilt rods (gear system hidden in stiles) c. Custom color match d. Decorative Bell curve			
FREEBIE OPTIONS	a. Frame sill cuts b. Astragal panels c. Tilt rod splits d. Flat frame/ panel options e. Divider rails or t-posts (standard 2" front) f. Mortised hinges			

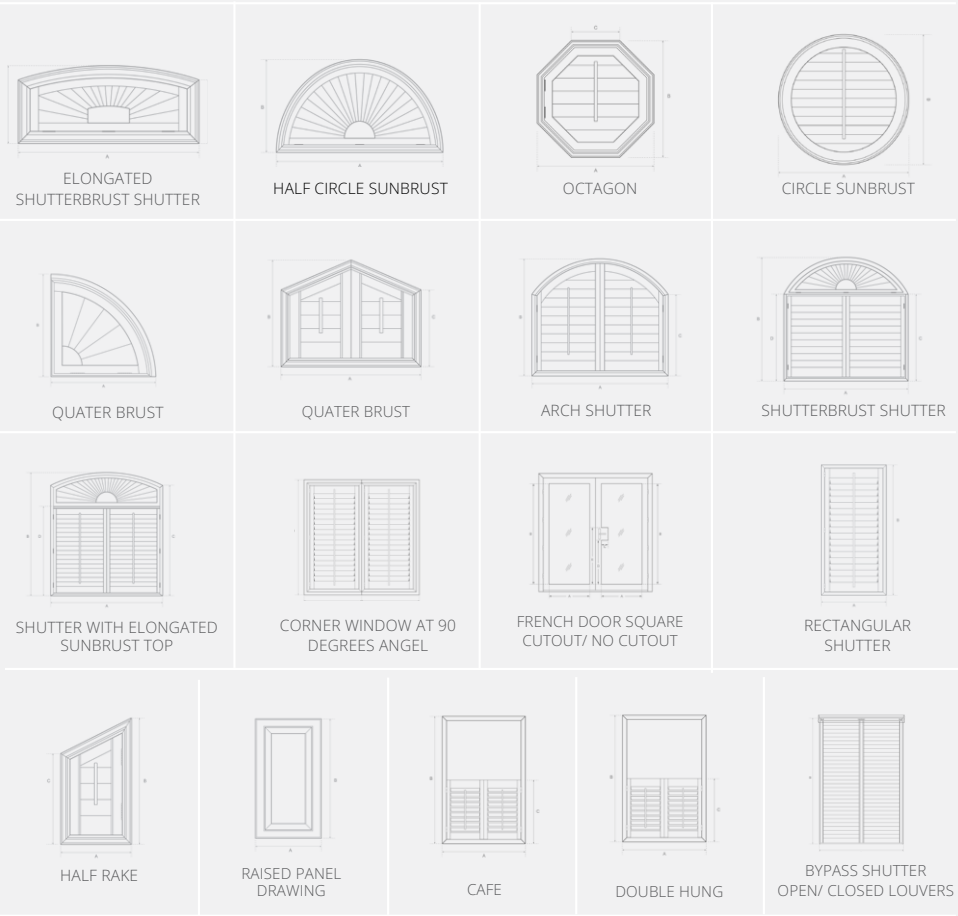



STYLE MEETS CHARACTER

Montecito Drapery

Drapery are once again making a fashion statement in both homes and offices. Smartly designed custom draperies add a touch of sophistication and create striking, dramatic effects in any interior space. With their rich depth and texture, drapery do more than just frame a window—they bring a room to life.

More than 100 fabrics to choose from, each drapery panel is made with exceptional quality and timeless beauty.

MONTECITO DRAPERY

UNIQUE STYLE THAT FITS YOUR SPACE



FABRIC OPTIONS	Linen, Velvet, Textured Sheer, Blackout Liners
PRODUCT MEASUREMENT	Width: Unlimited per panel (some panels may be sewn together) Height: standard 106" limit, custom height available
OPTIONS	Double Pinch Pleat, Tripple Pinch Pleat, Velvet Pinch Pleat Back Tab, Body Memory, Fire Retardant Treatment
HARDWARE	<div>1" wall mount Traversing rods in colors black and white 1" ceiling mount track, color off white, bendable for corners</div> <div><div>TRaversing RODS</div><div><div>FD77</div><div>FD772</div><div></div></div></div>





MINIMAL& FLAWLESS

Newport Shades

Newport Shades are a sleek and trendy window covering option, perfect for achieving a clean, modern aesthetic in any space. Available in a wide range of materials—from decorative sheers that gently filter light to functional blackout fabrics that provide complete privacy and light control—Newport Shades offer both style and versatility.

Crafted in our local workrooms or by trusted U.S.-based partners, our Newport Shades are made with the highest quality standards, ensuring durability, beauty, and performance. Plus, we offer quick turnaround times and competitive pricing, making it easier than ever to upgrade your windows with confidence.

NEWPORT SHADES

UNIQUE STYLE THAT FITS YOUR SPACE

Fairway Decor Newport Shades present a clean, modern style in fresh, on-trend fabrics—from sheer to blackout. You'll find roller window shades fit any window, including your extra-wide windows.



FABRIC	Vertilux brand, Yuma brand
TYPES	Blackouts, Light filtering in Percentages Duel Shades Outdoor Shades Motorized, Cordless Featherlite
AUTOMATION	Somfy Motors, Smart Hubs, Alpha Tubular Motors, Smart Hubs





ELEVATED & MODERN

Sedona Wall Panels

Wall panels are a stylish and functional way to enhance every room in your home or office. Explore our fabulous selection of decorative wall panels, designed to add texture, depth, and visual interest to any space—from living rooms and bedrooms to offices and creative studios. These panels not only elevate your interior design but also offer practical benefits such as sound absorption and utility functions.

Installation is simple and flexible—mount them on walls or ceilings using nails, screws, or construction adhesive. Whether you're aiming to create a cozy atmosphere or a bold statement wall, our panels help supercharge your space for creativity and productivity.

SEDONA WALL PANELS

UNIQUE STYLE THAT FITS YOUR SPACE

Crafted from durable composite materials and enhanced with fire-retardant foam, our Sedona wall panels are designed for both beauty and performance. Whether you're working with flat walls or curved surfaces, these panels offer flexible installation options to suit any design vision.

Choose from our standard in-stock selections or opt for customized colors and materials tailored to your specific project requirements. Perfect for residential, commercial, or creative spaces, our wall panels combine aesthetic appeal, safety, and functionality in one seamless solution.



COLORS	American Walnut, Natural Oak, Luxury Black, Wide Walnut, Wide Oak, Custom Color
SIZE	24" x 108" x 13/16"
MATERIALS	Engineered Wood with Black Foam Board (Standard) Basswood with Black Foam Board (Custom) Basswood with Solid Wood Board (Custom) Sycamore Wood with Solid Wood Board (Custom)
INSTALLATION	Nails, Screws, Construction grade Adhesive

WOOD COLORS



1 5/8
Oak



1 5/8
Walnut



WP-05
Luxury
Black



WP-02
Natural
Oak



WP-01
American
Walnut





ELEVATED EXCELLENCE

Scottsdale Pergolas

Transform your patio or backyard into a true outdoor living space with our modern Scottsdale Pergolas. Designed for both style and function, these pergolas feature adjustable louvered tops that open to let in sunlight or close to provide shelter from rain—complete with built-in water drainage systems.

SCOTTSDALE PERGOLAS

UNIQUE STYLE THAT FITS YOUR SPACE

Ideal for patios, gardens, and outdoor living areas, aluminum louvered pergolas offer a low-maintenance solution for enjoying the outdoors year-round. Durable with rust resistance to withstand various weather conditions with minimal maintenance.



MODEL	FDP150	FD168	FD210
FRAME MATERIAL	Light Duty Standard 6063-T5 aluminum alloy	Medium duty International Standard 6063-T5 aluminum alloy	Heavy duty International Standard 6063-T5 aluminum alloy
SIZE	12'w x8'l x10'h 14'w x10'l x 11'h	Custom Size	Custom Size
MOTORIZATION	Manual Crank	Remote Control	Remote Control
LED LIGHTS	None	Warm or Cool Color	Warm or Cool Color
COLORS	White or Dark Grey	White or Dark Grey	White or Dark Grey
OPTIONS	Side Screen	Side Screen	Side Screen
CONFIGURATION	4/6 posts modular	4/6 posts modular	4/6 posts modular
BEST FIT	Residential	Residential	Commercial



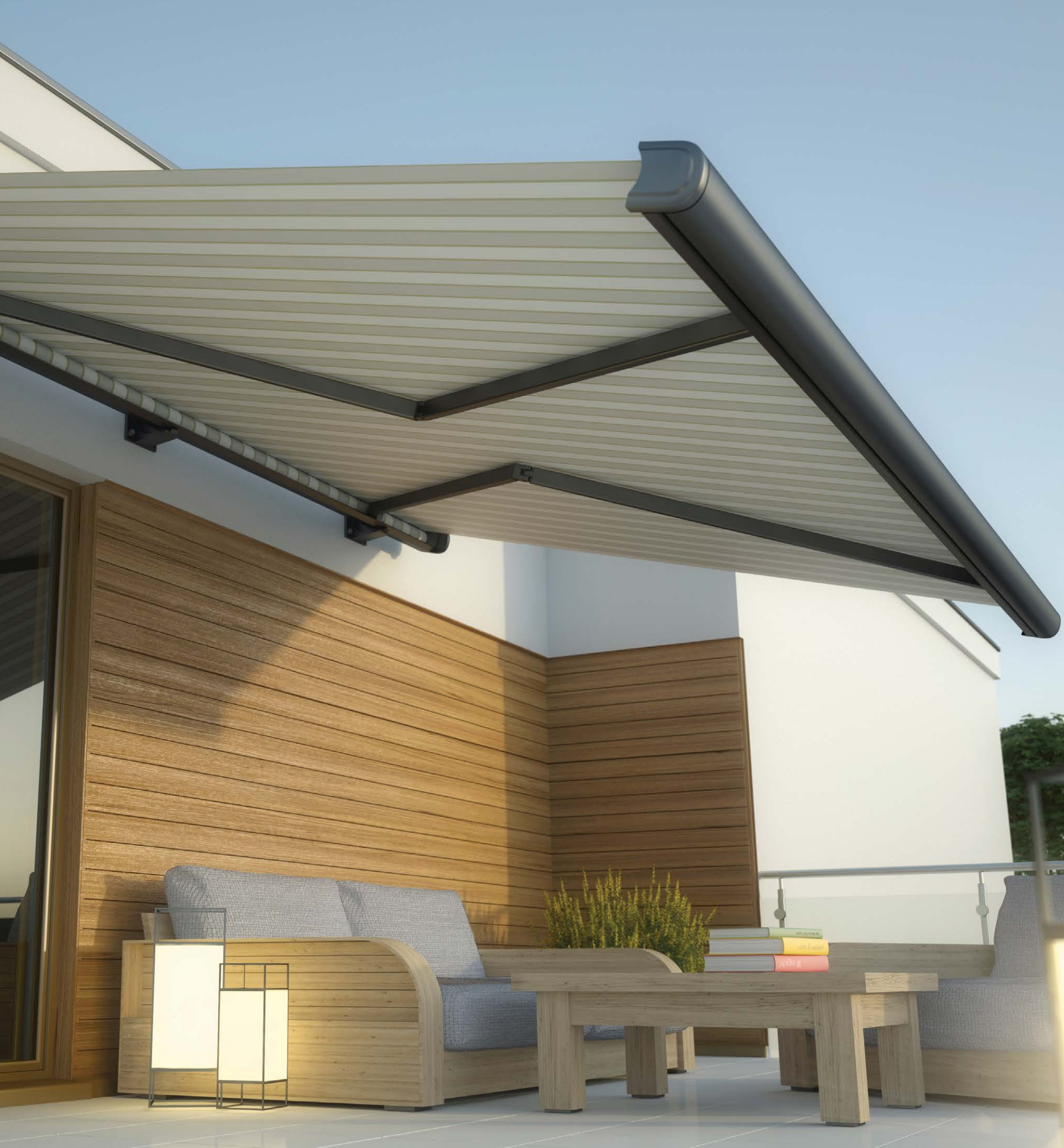

SOLUTIONS FOR PATIO, BALCONY & WINDOWS

Indio Awnings

Indio Awnings offer great flexibility to effectively provide shades, block the light and heat in a designated area. With the LED lights built in, you can also enjoy an evening event outdoors with your loved ones.

INDIO AWNINGS

UNIQUE STYLE THAT FITS YOUR SPACE

We offer a bespoke design service tailored to your unique needs. Our aesthetic retractable awnings will complement any property. Your stylish, sustainable solution for outdoor comfort.



MODEL	FDFB More traditional with a front fabric flap	FDQB European modern with enclosing casing when the unit is closed
PRODUCT FEATURES	Spanish Sauleda fabric (the same factory also makes sails for sail boats) Water resistant fabric LED light strips Optional Wind sensors for auto closure Heavy duty structure	

1. 2427 Aquamarina

2. 2242 Verde

3. 2245 Botella

4. 2101 Granate

5. 2209 Brasserie

6. 2211 Rojo

7. 2050 Naranja

8. 2013 Amarillo

9. 2146 Marrón

10. 2038 Beige

11. 2042 Blanco

12. 2102 Gris

13. 1488 Berry

14. 1063 Lagoon

15. 2316 Cafe

16. 2170 Negro

17. 2235 Azul Real

18. 2018 Azul

19. 2145 Marino
20. 2165 Marrón-x

21. 2212 Rojo-N

22. 2120 Kenia

23. 1477 Lagoon X

24. 2359 Azul Real-X

25. 2680 Botella-N

26. 1476 Sand X

27. 2818 Oslo

28. 2816 Estocolmo

29. 2815 Copenhagen

30. 2576 Aries

31. 2575 Leo
32. 2128 Tierra

33. 2179 Plutón

34. 2121Marte

35. 2701 Jamaica

36. 2702 Miami

37. 2238 Texas

38. 2251 Viena

39. 2154 Mónaco

40. 2063 Capri

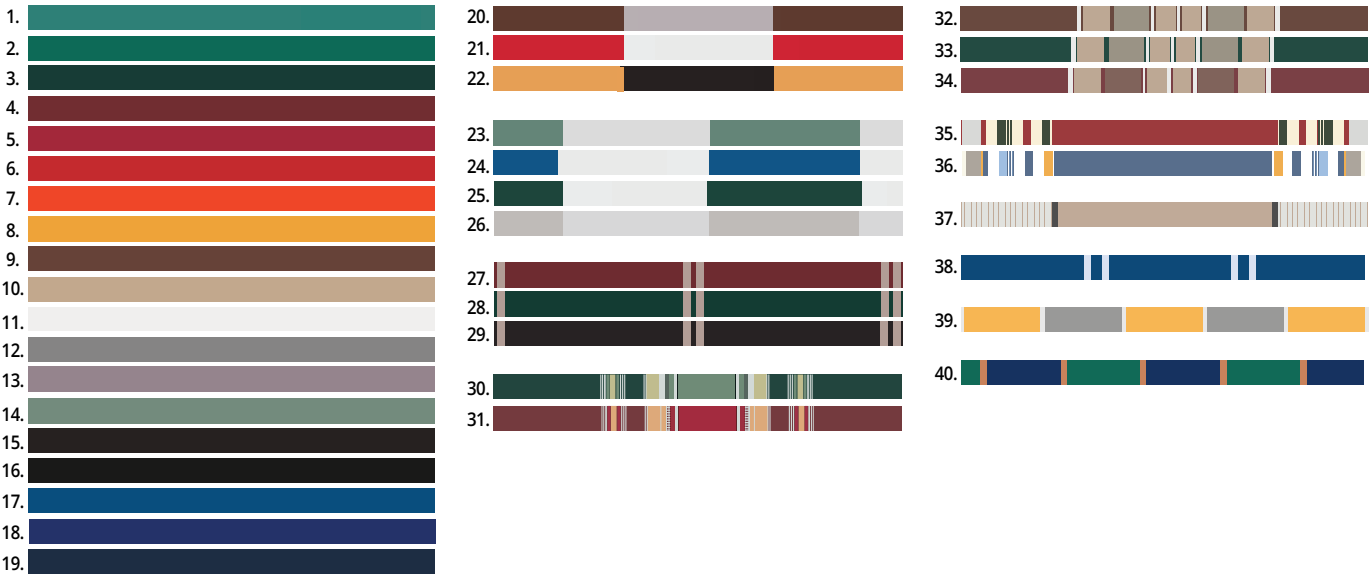



FAIRWAY — D É C O R —

PRODUCT CATALOG JULY 2025



📍 2028 E FRANCIS ST, ONTARIO, CALIFORNIA 91761
☎ 909.532.8818 ✉ customer@fairwaydecor.com
🌐 fairwaydecor.com